

Key points of Assembly

Section 2

- 1) If possible please have a Plus driver with size 000, if you need to fix the parts to the Main frames as per manual. If it is not possible to find the above size driver, then you have to assemble the Centre cylinder as below.
- 2) Once you finished the section 1, fix the part 2-9 and 2-10 to the cylinder after assembling the Fig.1 as per section 2. Then you have to fix the 2-8 to those parts and use a normal Plus driver size 0 to fix the screw M2-2.5 screws. After that fix the 2-21 rod and the assembly must be as per below photo. Then you can fix the Cylinder to the Main frame.

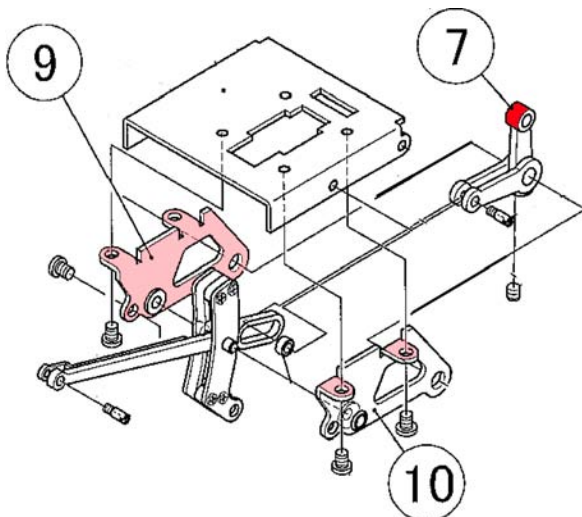
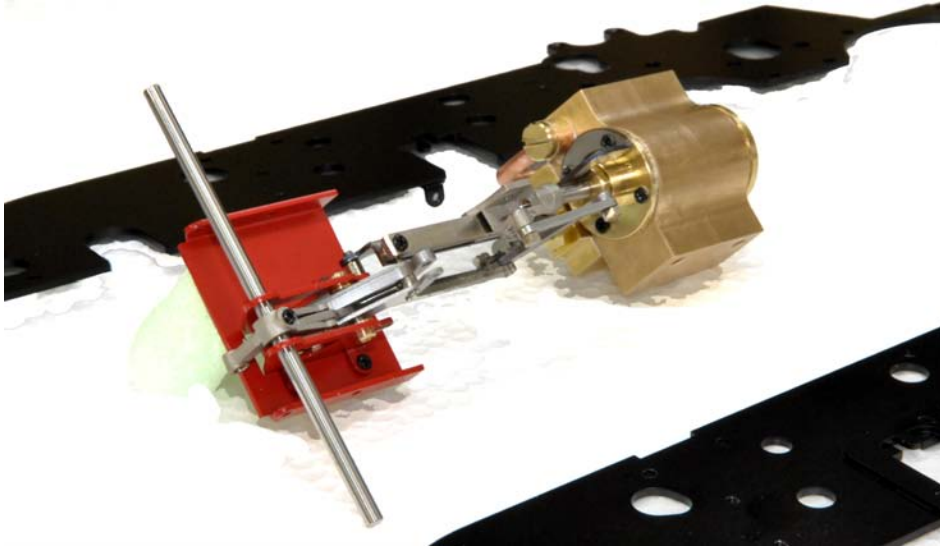

- 3) As shown by the left diagram it is necessary to file off the top of 2-7 as marked in red, so that it does not hit the 2-8 bottom side.

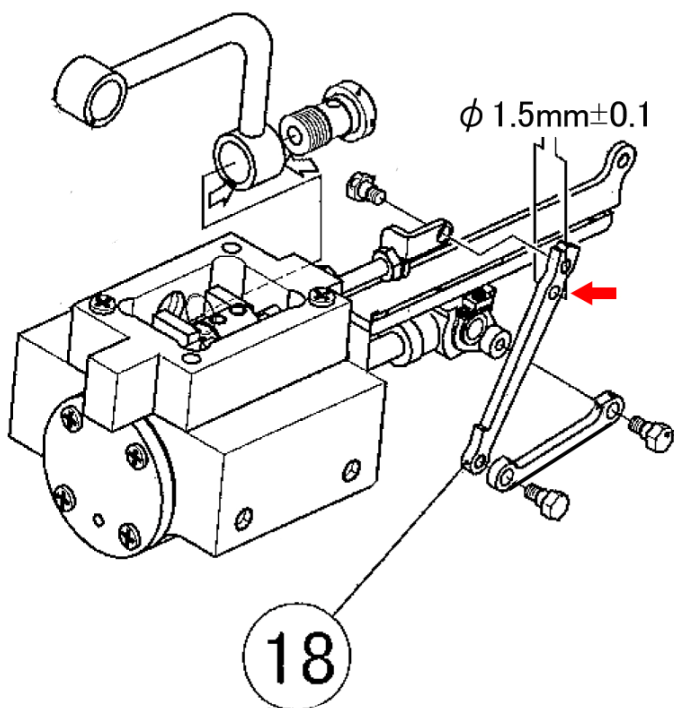

- 4) Part 2-18 - Please make the hole bigger, marked in red to make it to 1.65mm size and at present it is 1.5mm.

Section 4

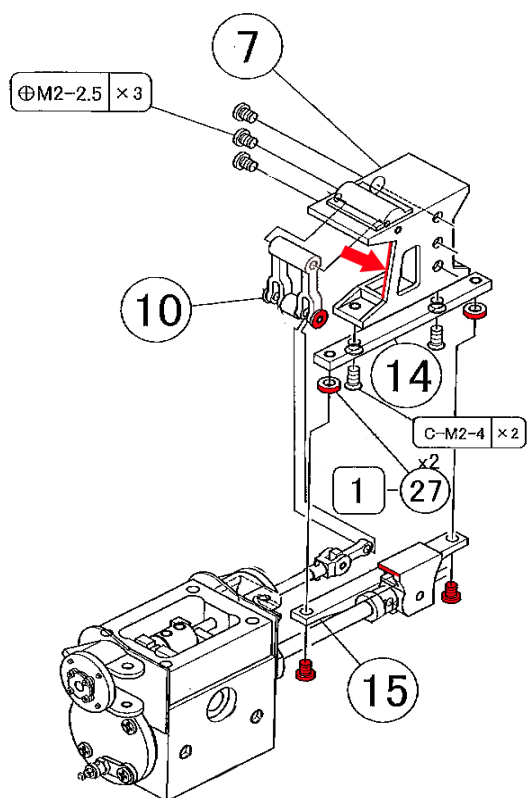

- 1) The parts marked in red 4-10 and 4-7 are LW parts, may be it is necessary to file off a bit in the area marked in red. Also may be it is necessary to file off the top of Cross head and to make it thinner.

2) After assembling the parts as per Fig. 4, if you find the +M1.4-6 is too long then file off them at the end.

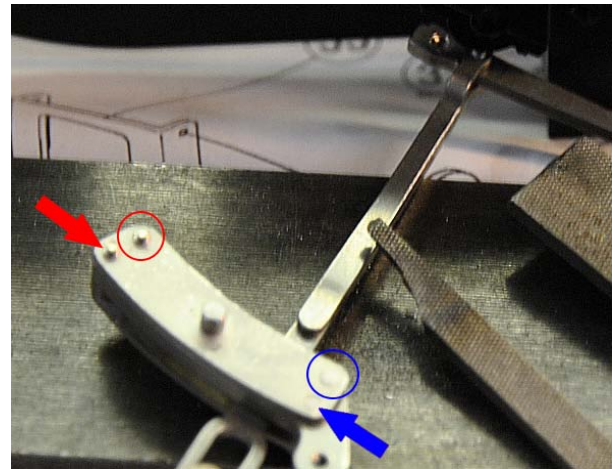
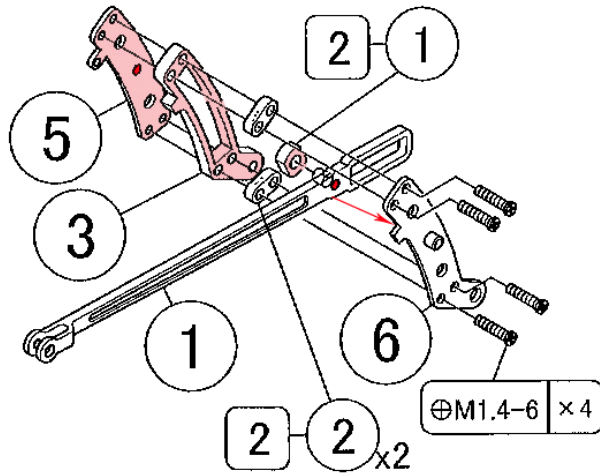

After finishing the Section 6 and 7 valve settings and when you set the Reverser lever to the neutral position, all the rods and wheels must be same as per illustration below.

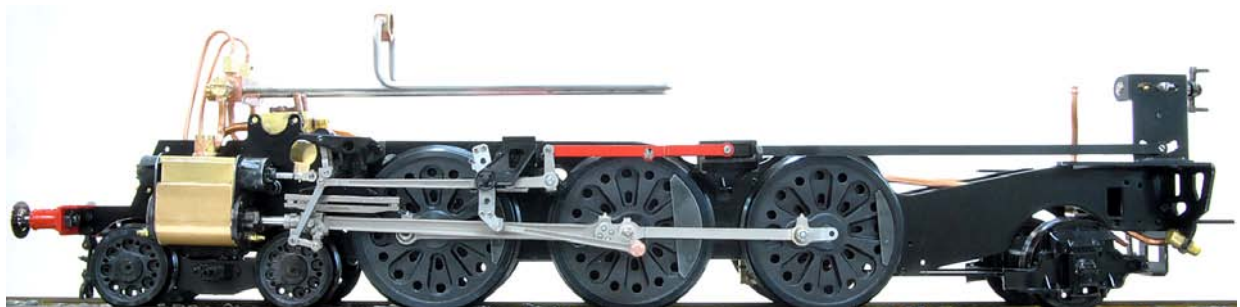
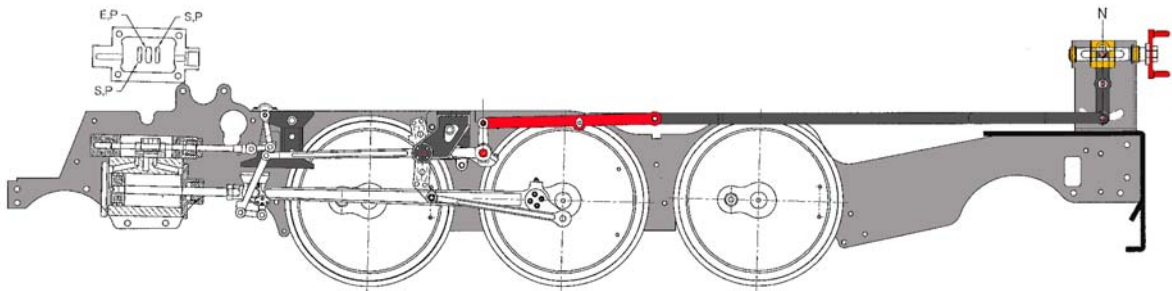

Section 10: The correct assemble position of water tube (as below)

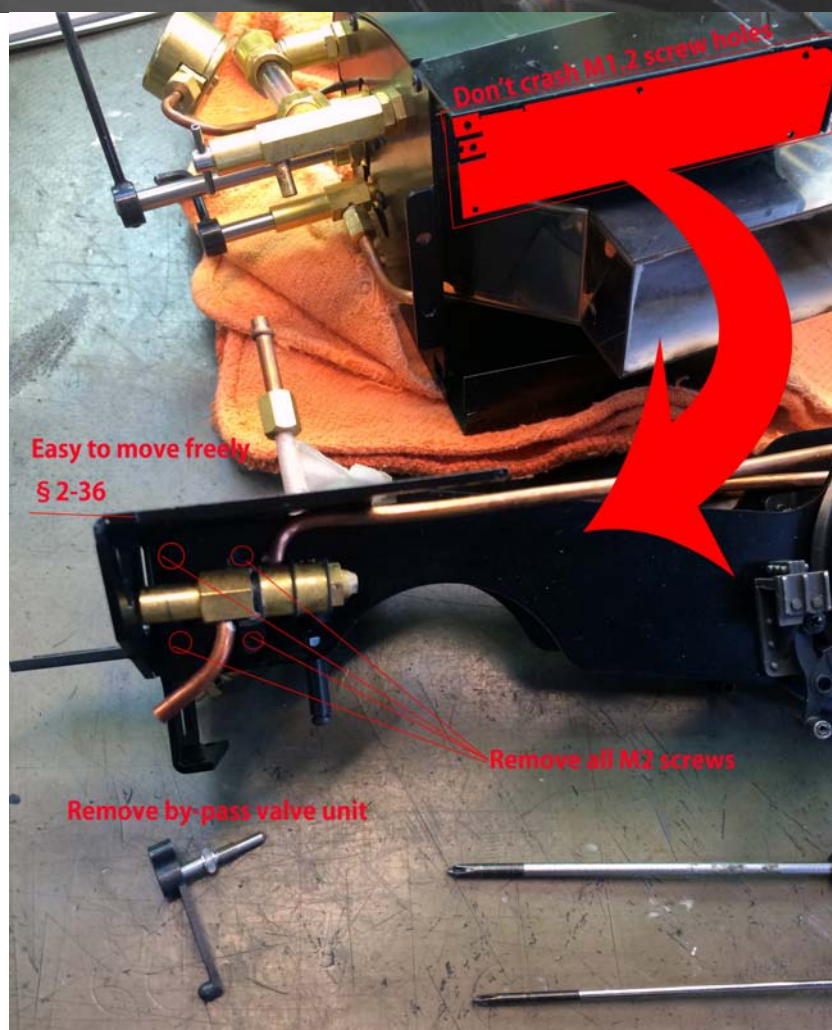

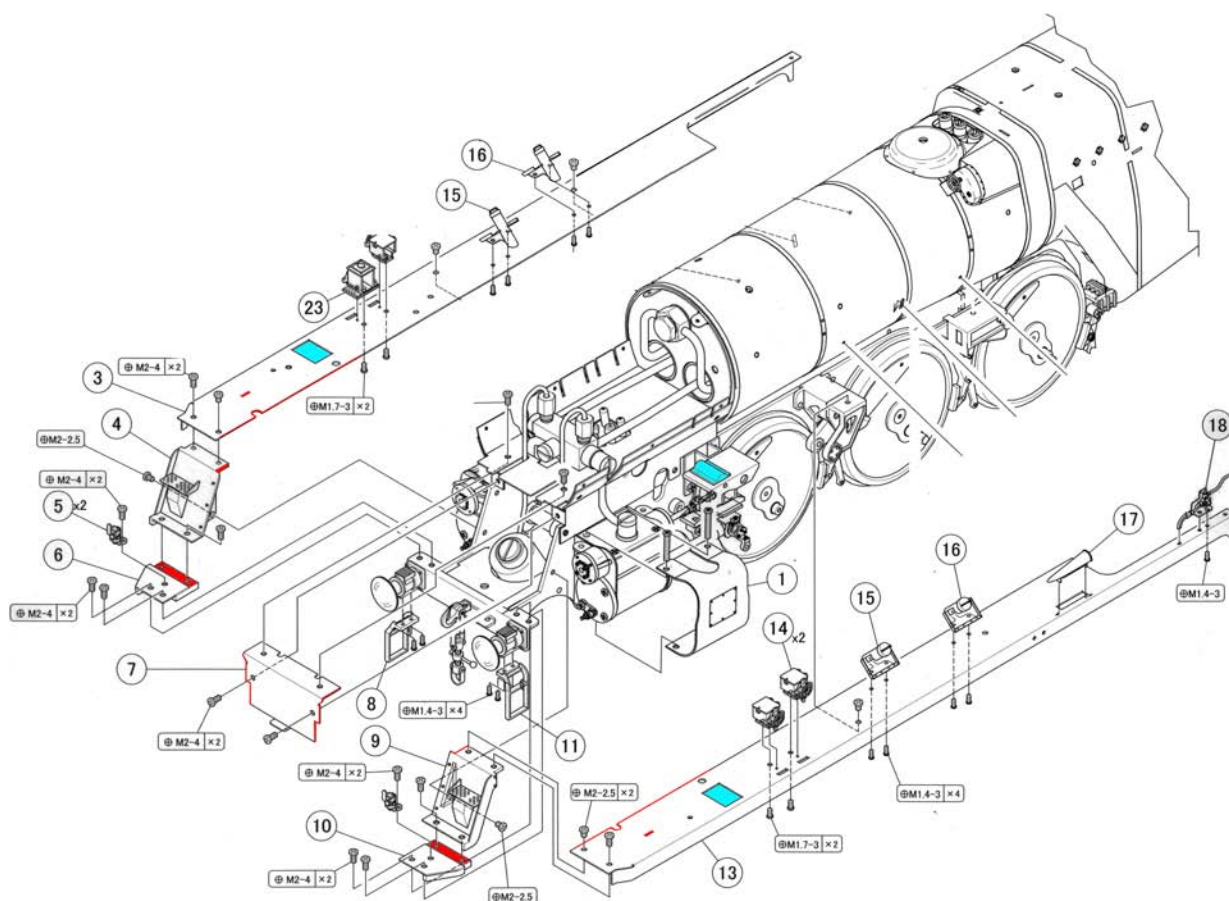
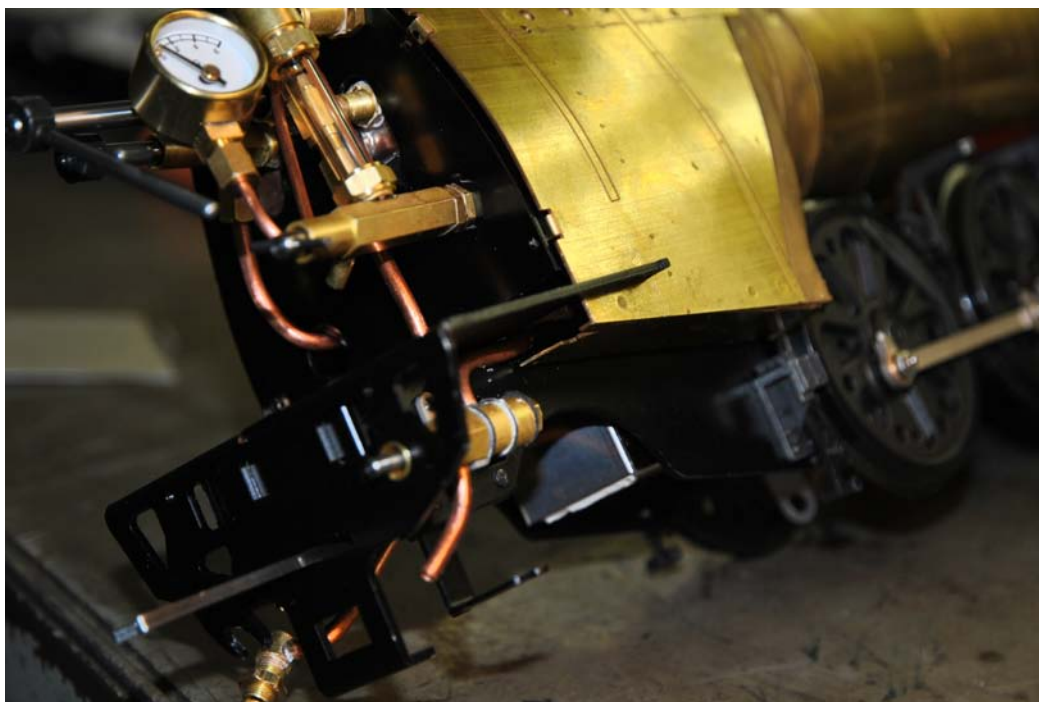

Section 11 - When you want to fix the running boards correctly, do not file off the places marked in Cyan color. Try to trim the positions marked in Red to file off and fix the running Board

Section 12 –

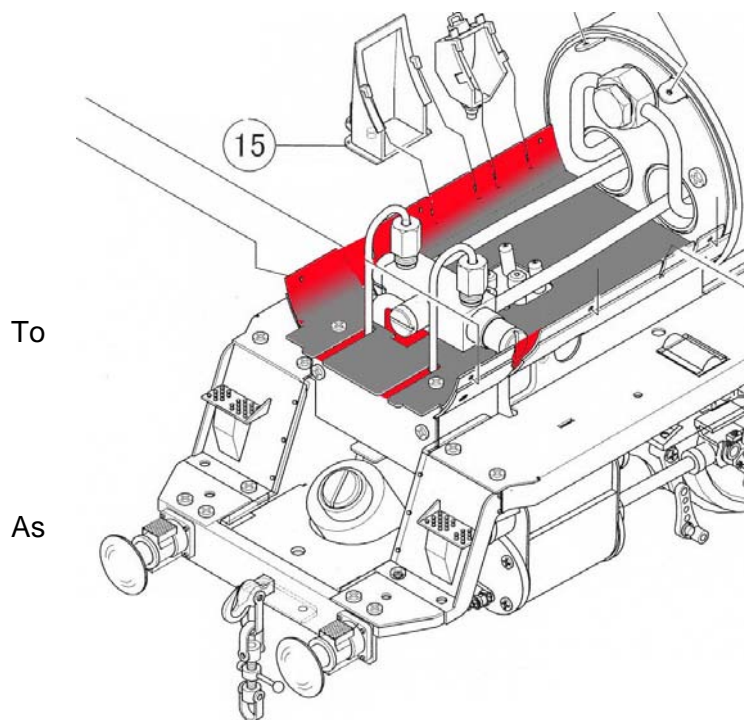

When you assemble the Smoke box 12- 9 to the Boiler cover, it is necessary to loose the screws M2-4 of the Back head 8-6.

Then after fixing the Smoke box cover you can tight the Back head screws. Do not try to squeeze the Smoke box cover and fix in to the Boiler case.

Stop the Air leaking, please fill the areas marked in Red with small pieces of ceramic sheet after applying packing compound.

per below diagram, please fix the parts 12-11, 12-12 and 12-13 to the Smoke box cover before you fix the Ceramic sheets.

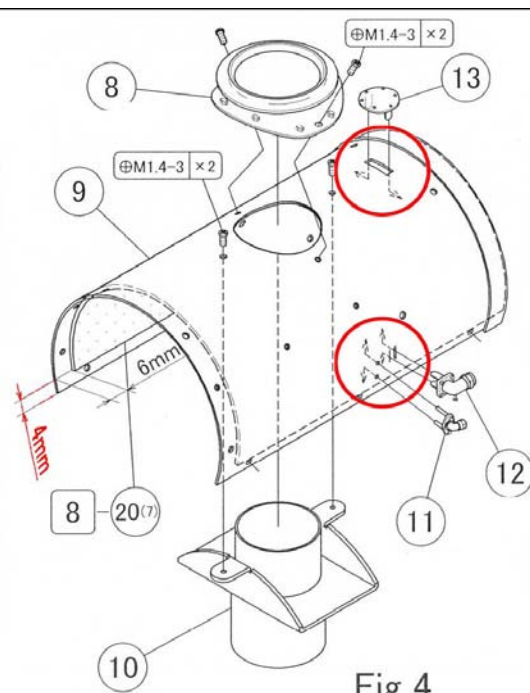

Fig 4